

# TECHNOSHOT

## TS2060i Replacement Guidance

[V806 > TS2060i]

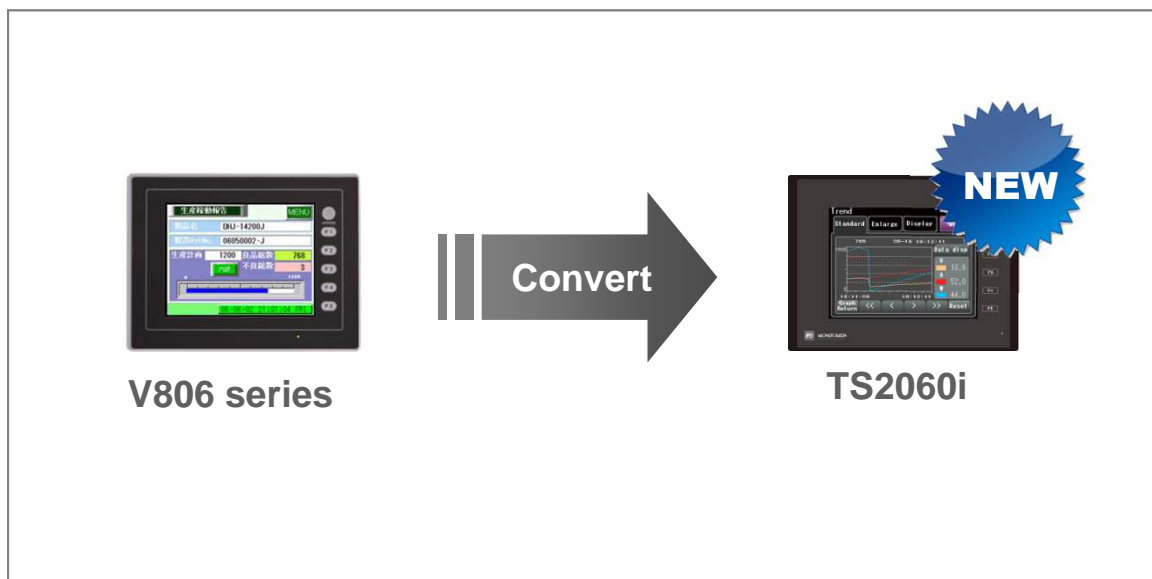

### - Model names of V806 series

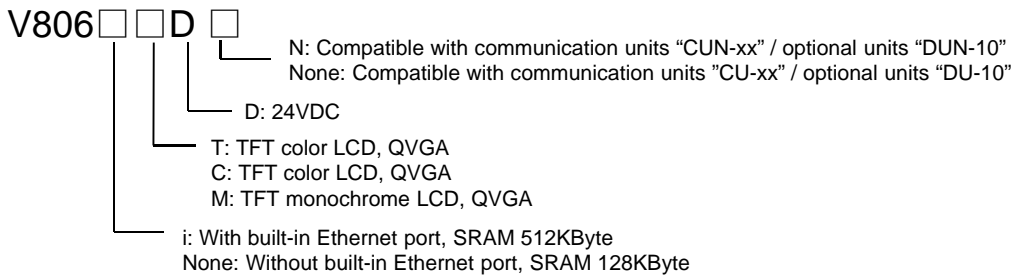

### - Main difference

	V806i/V806 series		
	V806iTD(N) V806TD(N)	V806iCD(N) V806CD(N)	V806iMD(N) V806MD(N)
Front view			
External dimensions (mm)			
Panel cut-out (mm)			
Display device	TFT color		TFT mono.
Display color	65,536 colors		16 shades of gray
Display area	5.7-inch		
Resolution	320 × 240 dots		
Memory	FROM	4.5 MB	
	SRAM	512 KB *1 / 128 KB	
Touch switch	Analog		
Com. I/F	Serial	CN1	D-Sub 9pin (with DU(N)-10): RS-232C / RS-422/485
		MJ1	Modular 8pin: RS-232C / RS-485 (2-wire)
		MJ2	Modular 8pin: RS-232C / RS-422 (4-wire) /485(2-wire)
	USB	USB-A, USB-B	
	Ethernet	1CH *1	
Network	Communication units: CU-xx/CUN-xx		
Storage	CF card (with DU-10/DUN-10)		
Power supply	24 VDC		
Power supply terminal	*2 For spade/ring terminals, Cross-recessed head screws		

Recommended replacement models	
TS2060i	
<b>TFT color</b>	
Color: 65,536 colors    Monochrome: 16 shades of gray	
5.7-inch	
320 × 240 dots	
<b>10.5 MB</b>	
<b>512 KB</b>	
Analog	
D-Sub 9pin ( <b>with DUR-00</b> ): RS-232C / RS-422/485	
Modular 8pin:RS-232C / RS-485 (2-wire)	
Modular 8pin: RS-232C / RS-422 (4-wire) /485 (2-wire)	
USB-A, <b>USB-miniB</b>	
1CH (Auto-MDIX)	
<b>Communication units: CUR-xx</b>	
<b>SD/SDHC card (built-in slot)</b>	
24 VDC	
<b>For blade terminals, Slotted head screws</b>	

\*1 Only V806iTDN/V806iCDN/V806iMDN

\*2 For the details, please refer to page 3.

## - Power supply terminals

Both of the power supply terminals differ in form. If the power cable is connected to the power supply terminal with spade/ring terminals, it requires to process the terminals of the cable. Please connect frame ground wires for communication to the terminal for frame ground.

### - V806 series

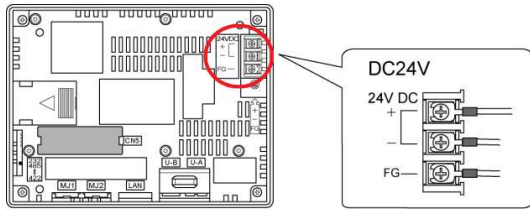

### - Power cable specifications

Power cables, frame ground wires: 16 to 14 AWG

### - TS2060

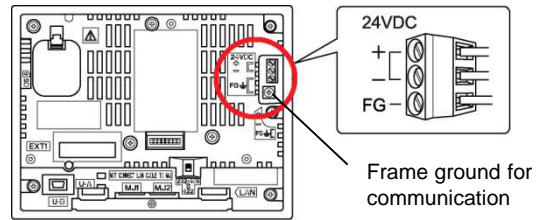

**\*It requires to tighten screws of the power supply terminal with a flat head screwdriver.**

Recommended flat head screwdriver :  
Phoenix Contact SZS 0.6 x 3.5

### - Power cable specifications

<b>When the cable is directly connected to the power supply terminal</b>	Power cable: 18 to 14 AWG Stranded/solid cable (1.0 to 1.6 mm in diameter) FG wire: 20 to 14 AWG Stranded/solid cable (0.8 to 1.6 mm in diameter)
<b>When the cable is connected to the power supply terminal with blade terminals</b>	Recommended blade terminal: AI 0.75-6 GY, AI 1-6 RD, AI 1.5-6 BK (Phoenix Contact)  Recommended crimping tool: CRIMPFOX 6 (Phoenix Contact)

## - Screen program transfer

### [V806 series]

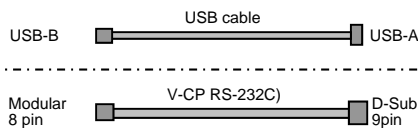

\*It is also possible to transfer screen programs with CF cards or via Ethernet (It requires to use models with a Ethernet port or models with "CU-03-3"/"CUN-03-3").

### V-SFT-5 (Ver. 5)

Windows 98SE / NT4.0 / Me / 2000 / XP / XP 64 Edition / Vista (32bit, 64bit) / 7 (32bit, 64bit) / 8 (32bit, 64bit) / 8.1 (32bit, 64bit)

### [TS2060i]

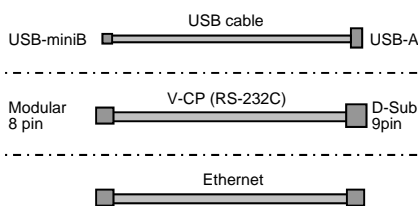

\*It is also possible to transfer screen programs with SD cards or USB flash drives.

\*An Ethernet port of TS2060i has Auto-MDIX. It is possible to use both straight and crossover cables regardless of plugging a hub.

### V-SFT-6 (Ver. 6.0.16.0 or later)

Windows XP / XP 64 Edition / Vista (32bit, 64bit) / 7 (32bit, 64bit) / 8 (32bit, 64bit) / 8.1 (32bit, 64bit) / 10 (32bit, 64bit)

## - Screen program conversion

It is possible to convert screen programs of V806 to the programs of TS2060i with V-SFT-6 (configuration software).

Open the screen programs of V806 on V-SFT-6, click [System Setting] and then [Edit Model Selection], and change [Edit Model] to TS2060i.

\*We recommend models less restricted in use in this document. Because it is possible to replace your HMI with models other than the recommended one, please select models depending on your system.

# Hakko Electronics Co., Ltd.

Overseas Sales Dept.

TEL: +81-76-274-2144 FAX: +81-76-274-5136

<http://monitouch.fujielectric.com/>