

MONITOUCH PLUS EXPRESS

IAI Corporation

Issue No. 24
2010

Introduction of ROBO Cylinder Connections

Merits of MONITOUCH connecting to ROBO Cylinder

- It is easy to manage JOG/inching operation that needs for teaching.
- It is easy to change the settings of multiple ROBO Cylinders by one MONITOUCH.
- It is easy to design screen programs of a ROBO Cylinder with few steps.

[Traditional way] Operated the setting management of a ROBO Cylinder by using a teaching pendant

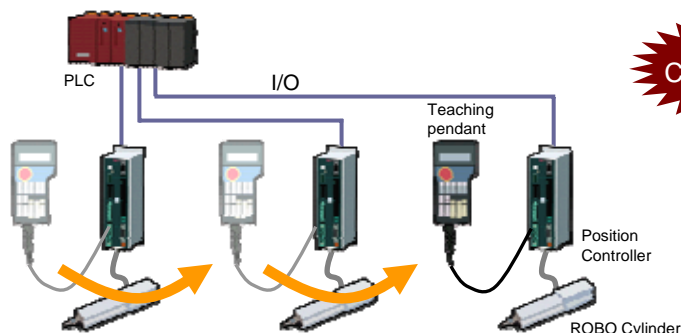

Complaint

- It was stressful to set multiple ROBO Cylinders.
- It was stressful to bring a teaching pendant to a factory.



TEACHING OPERATION BY MONITOUCH

A double role!!

- 1) It is able to operate teaching of ROBO Cylinders.
- 2) It is possible to read/write the memories of PLC.



Unnecessary
Pendant PC

Reduction
of wiring
steps

Multiple connection is possible!!

By connecting via RS-485, it is possible to connect one MONITOUCH to multiple ROBO Cylinders.

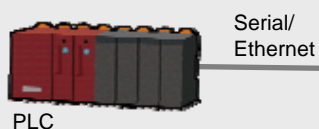

MONITOUCH
V8 Series

RS-485

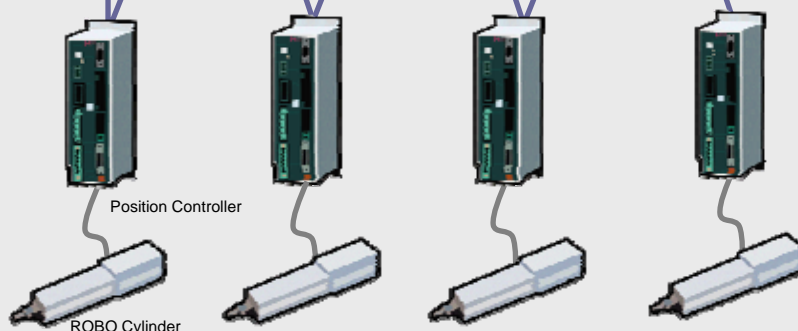

[Supported models of controllers made by IAI]

The type of Models	PCON/ACON/SCON RCP2/ERC RCS/E-CON X-SEL PSEL/ASEL/SSEL
--------------------	--

In addition, steps to create screens are reduced by using Component Parts.

Differences from Sample Screens!! Merits of Component Parts

By using Sample Screens

- It was necessary to copy each page one by one if the sample screens consisted of multiple pages.
- It was necessary to change the property of parts in a screen that jumped to a dedicated screen if the screen numbers in the sample program differed from the ones in your screen program that you are going to copy to.
- It was necessary to change memory addresses when the memory addresses used in the sample program and your program were overlapped.



Just place Component Parts when you use them

- It is possible to use component parts wherever you place them.
- It is possible to place component parts in a screen without worries of organizing a screen design.



- Easy to setup the parts



Placing a component part by choosing it



It is possible to set up multiple screens as a component part already includes them.

- Possible to arrange existing screen programs.

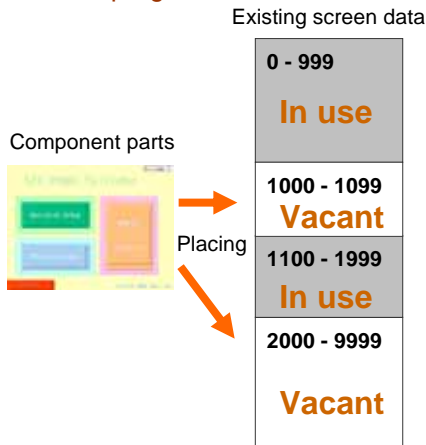

It is able to place component parts in any screen without worries.

- Unnecessary to worry memory overlapping due to using dedicated memories.



Component parts with dedicated memory

\$C:
4096 words

It is not to worry about memory overlapping with existing screen program as it uses dedicated memories.

Free version upgrade of the configuration software V-SFT-5



The configuration software (upgraded version) can be downloaded from the following website.
(Membership registration is required.)

Website:

<http://www.hakko-elec.co.jp/en/download/09vsft5/index.php>